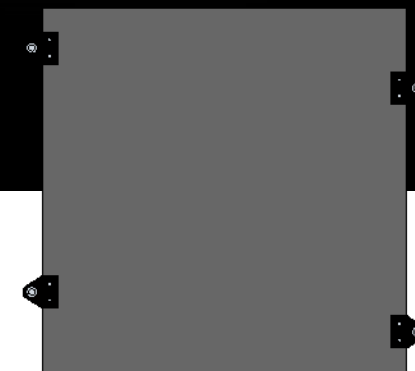

TABLE OF CONTENTS

1. CONCEPT RENDERING
2. THEATRE GROUND PLAN, NORTH AND SOUTH WALLS
3. EAST AND WEST WALLS
4. PANELS A AND A-S
5. PANELS B AND B-S
6. PANELS D AND D-S
7. PANELS E AND E-S
8. PANEL DETAILS
9. STANDARD BRACKET SUPPORTS
10. D AND E BRACKET SUPPORTS
11. GENERAL NOTES AND CONSTRUCTION SUGGESTIONS
12. MATERIALS AND INVENTORIES



Modular Panel Concept

Scale: None

1



UNIVERSITY OF  
PITTSBURGH

stages

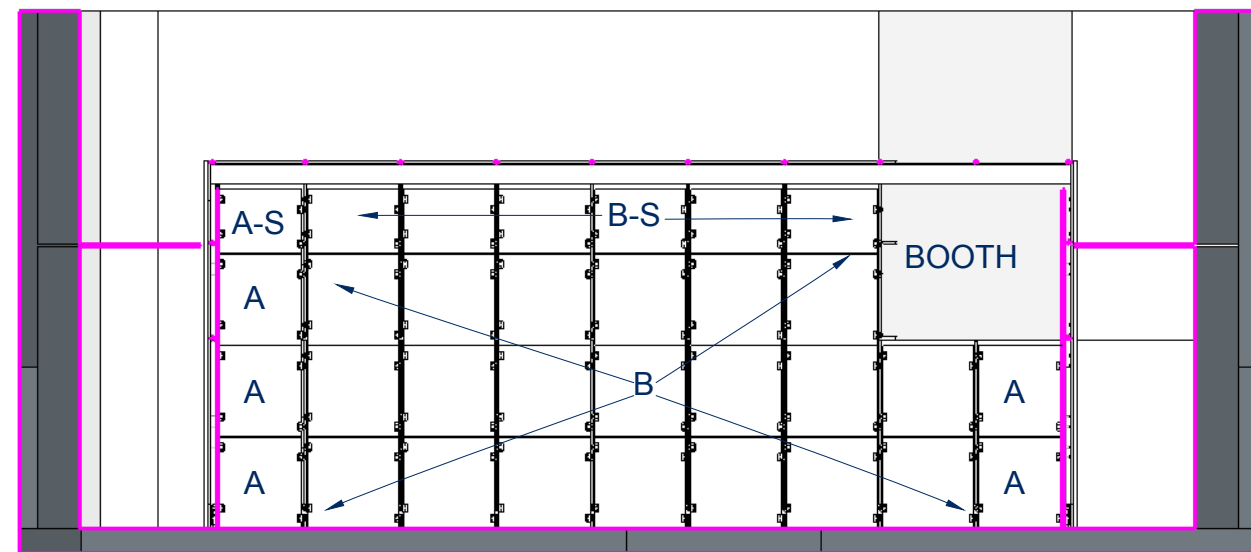
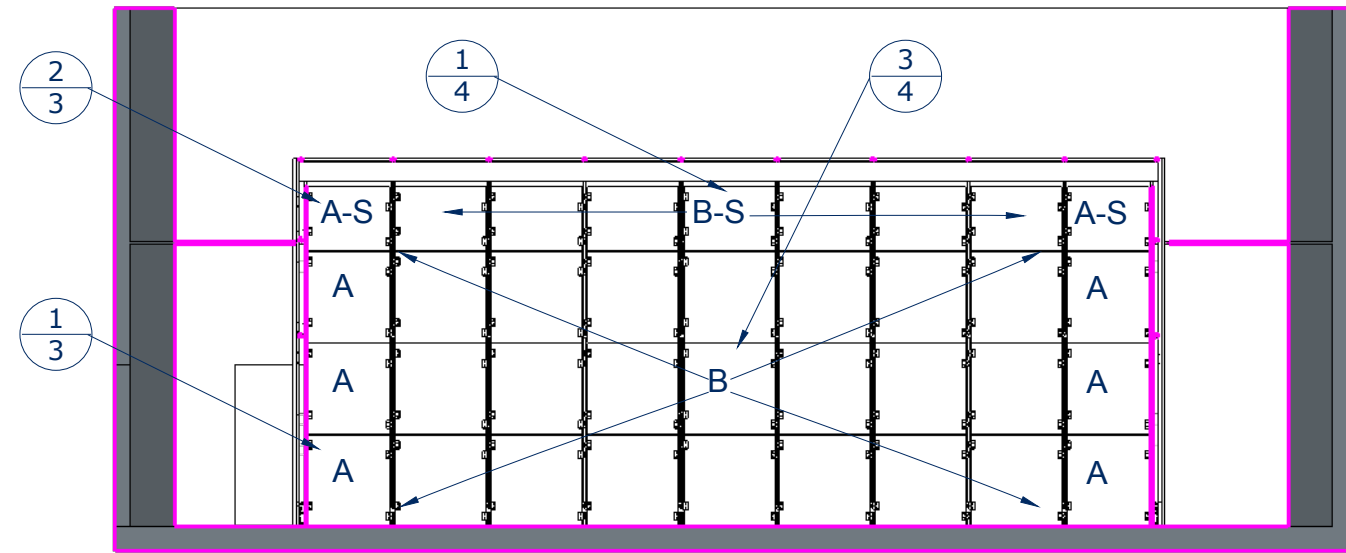
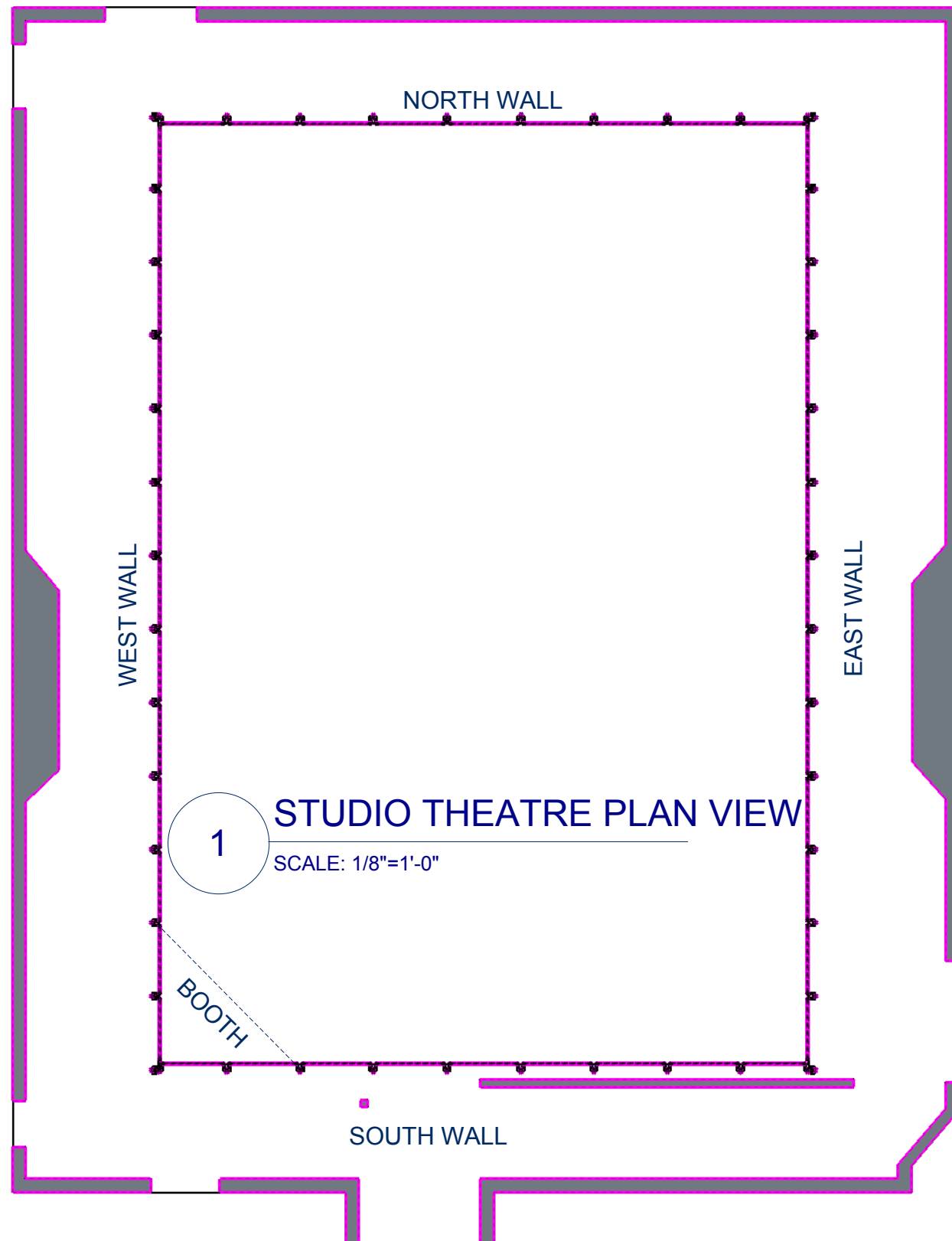

UNIVERSITY OF  
PITTSBURGH

**STUDIO THEATRE RENOVATION MODULAR PANEL CONCEPT**

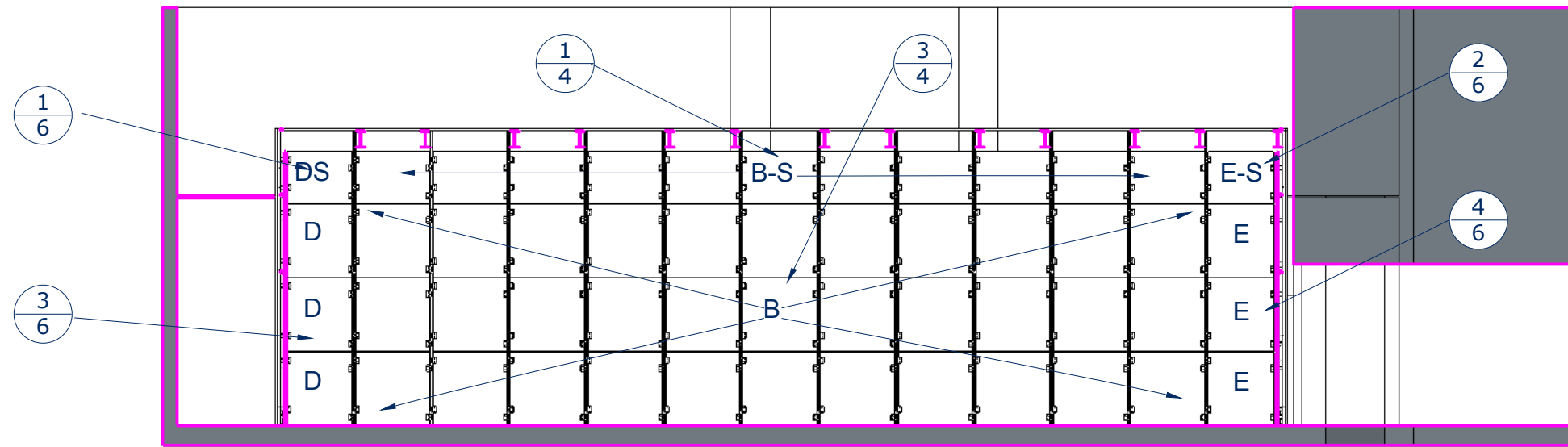

**1** STUDIO THEATRE EAST VIEW  
SCALE: 1/8"=1'-0"

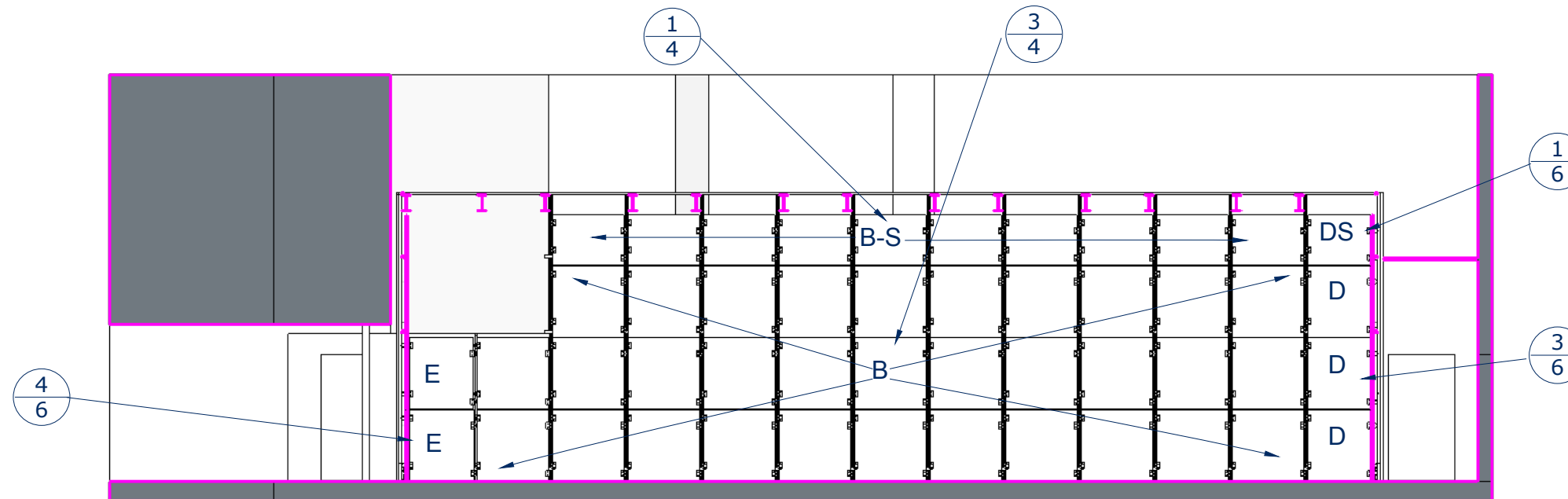

**2** STUDIO THEATRE WEST VIEW  
SCALE: 1/8"=1'-0"

**STUDIO THEATRE RENOVATION MODULAR PANEL CONCEPT**





TOP VIEW



LEFT SIDE VIEW

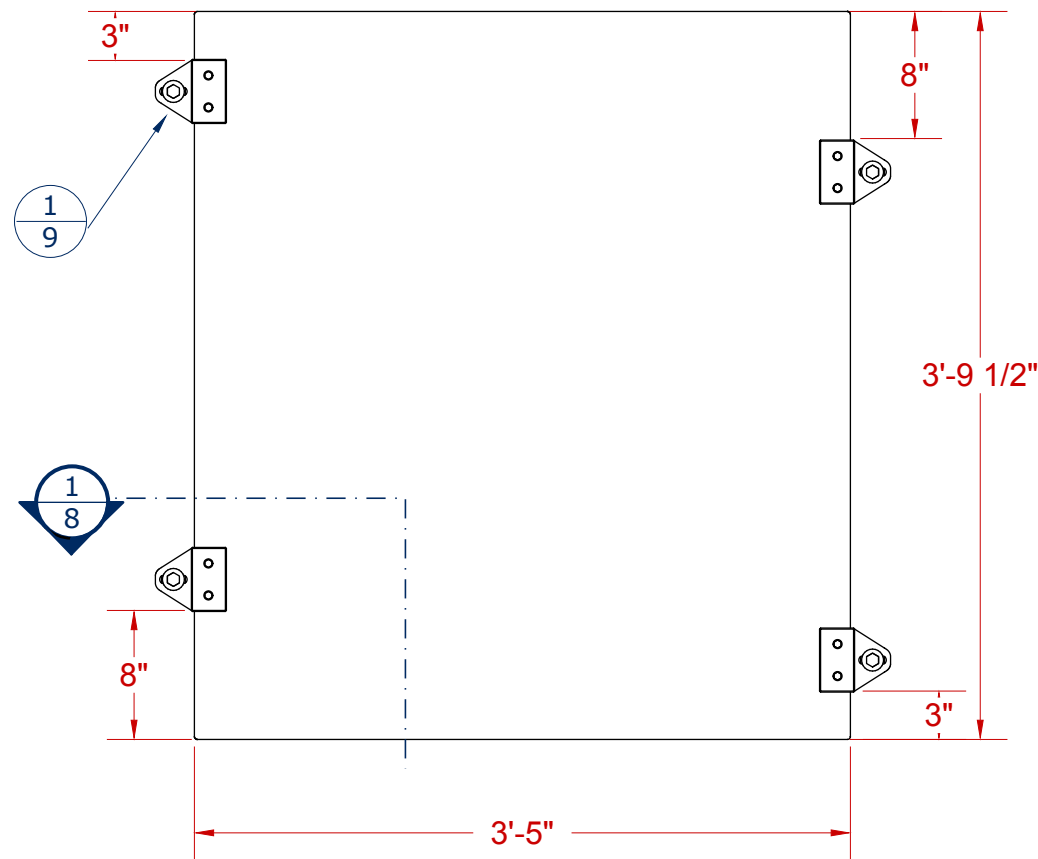

FRONT ELEVATION

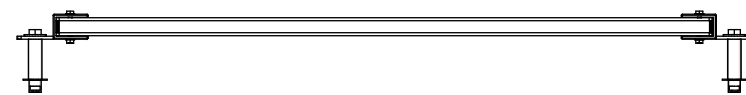

BOTTOM VIEW

**1** PANEL A  
SCALE: 1"=1'-0"

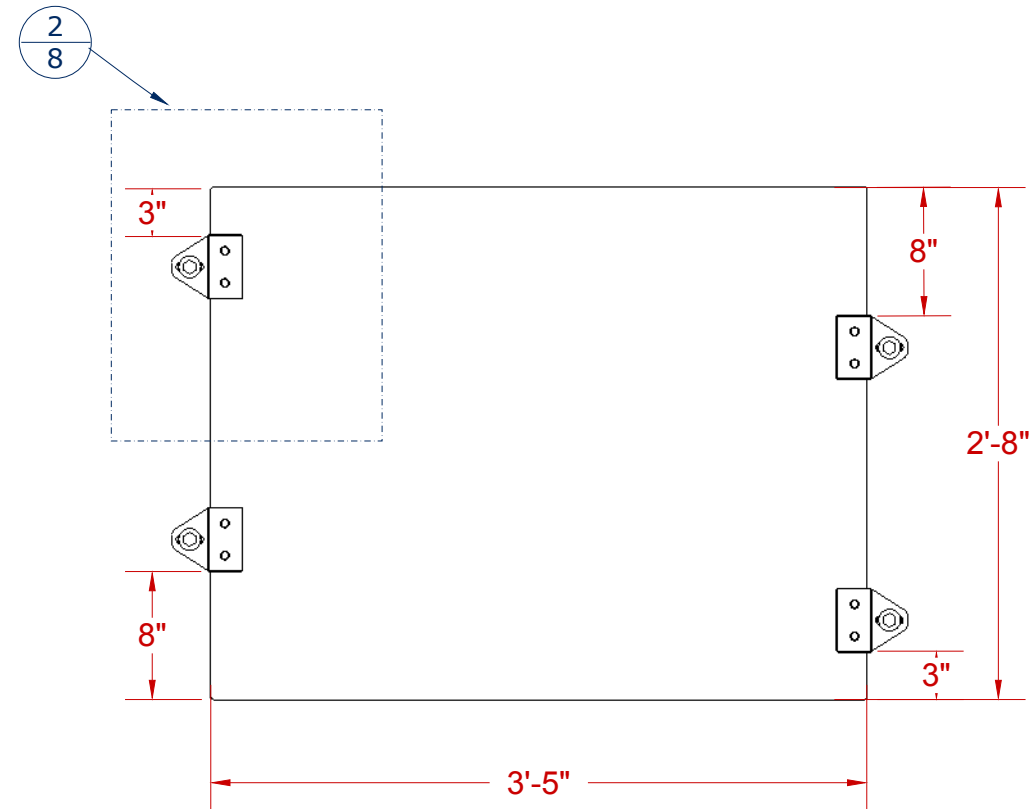

**2** PANEL A-S  
SCALE: 1"=1'-0"

NOTES:

1. ALL OUTER EDGES OF PANELS SHOULD BE ROUNDED OVER AT LEAST 1/8"
2. EACH PANEL HAS 4 BRACKETS AT CONSISTENT POSITIONING FOR MODULAR INSTALLATION
3. FRONT FACE OF EACH PANEL IS BLACK SINTRA, THE BACK DARK GREY SINTRA, AND SURROUNDING 4 SIDES ARE BUILT WITH BLACK SINTRA
4. BRACKETS ARE STEEL, PAINTED WITH A LOW LUSTER BLACK SUPER SPEC PAINT, WITH ZINC PLATED FASTENERS
5. BUILD 12 "A" PANELS AND 4 "A-S" PANELS



UNIVERSITY OF  
PITTSBURGH

STUDIO THEATRE RENOVATION MODULAR PANEL CONCEPT



TOP VIEW



LEFT SIDE VIEW

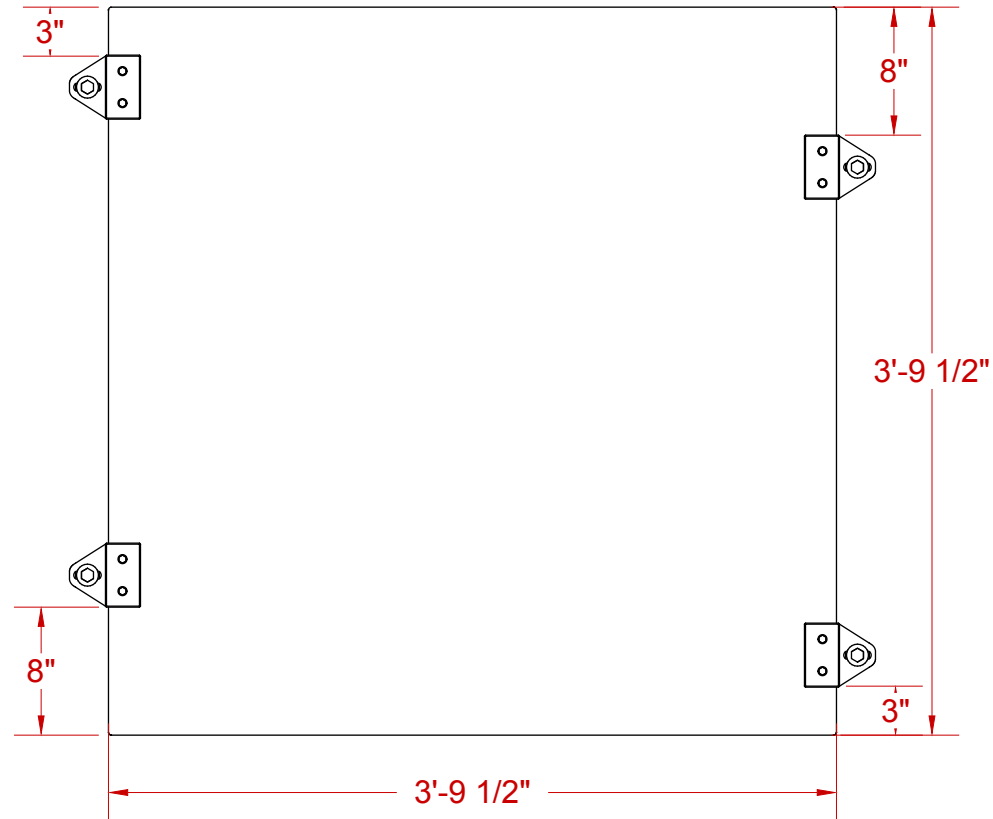

FRONT ELEVATION



BOTTOM VIEW

**1** PANEL B  
SCALE: 1"=1'-0"



RIGHT SIDE VIEW

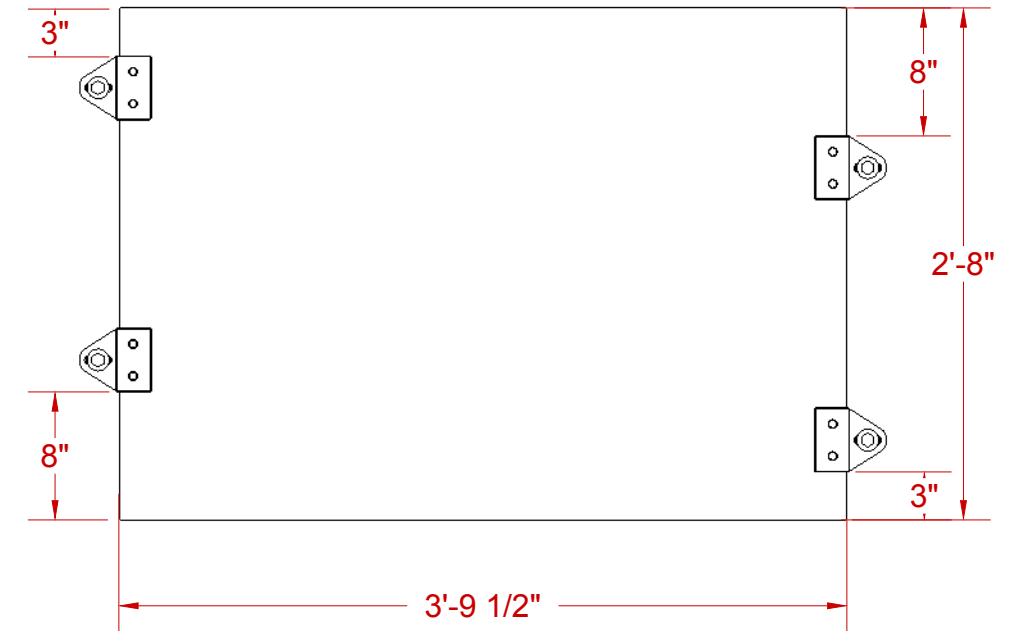

**2** PANEL B-S  
SCALE: 1"=1'-0"

**NOTES:**

1. ALL OUTER EDGES OF PANELS SHOULD BE ROUNDED OVER AT LEAST 1/8"
2. EACH PANEL HAS 4 BRACKETS AT CONSISTENT POSITIONING FOR MODULAR INSTALLATION
3. FRONT FACE OF EACH PANEL IS BLACK SINTRA, THE BACK DARK GREY SINTRA, AND SURROUNDING 4 SIDES ARE BUILT WITH BLACK SINTRA
4. BRACKETS ARE STEEL, PAINTED WITH A LOW LUSTER BLACK SUPER SPEC PAINT, WITH ZINC PLATED FASTENERS
5. BUILD 110 "B" PANELS AND 36 "B-S" PANELS



UNIVERSITY OF  
PITTSBURGH

**STUDIO THEATRE RENOVATION MODULAR PANEL CONCEPT**



TOP VIEW

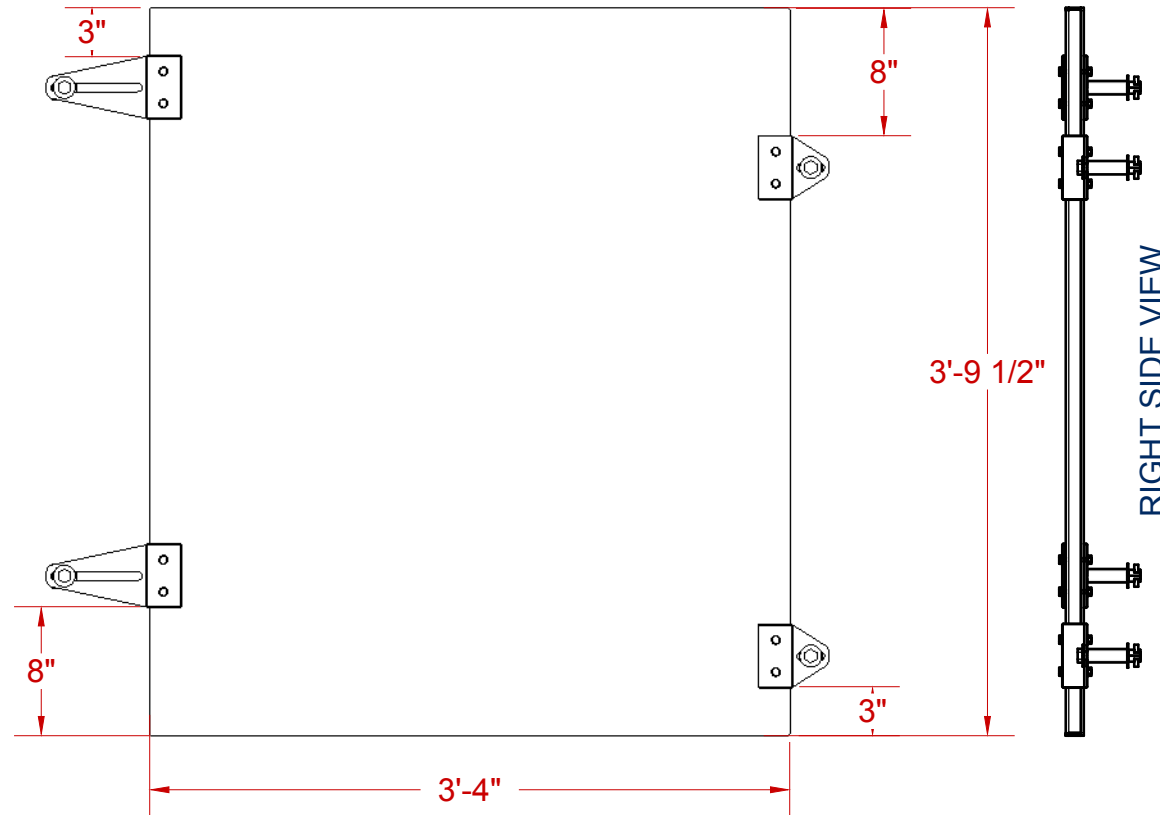

FRONT ELEVATION



BOTTOM VIEW

**1** PANEL D  
SCALE: 1"=1'-0"

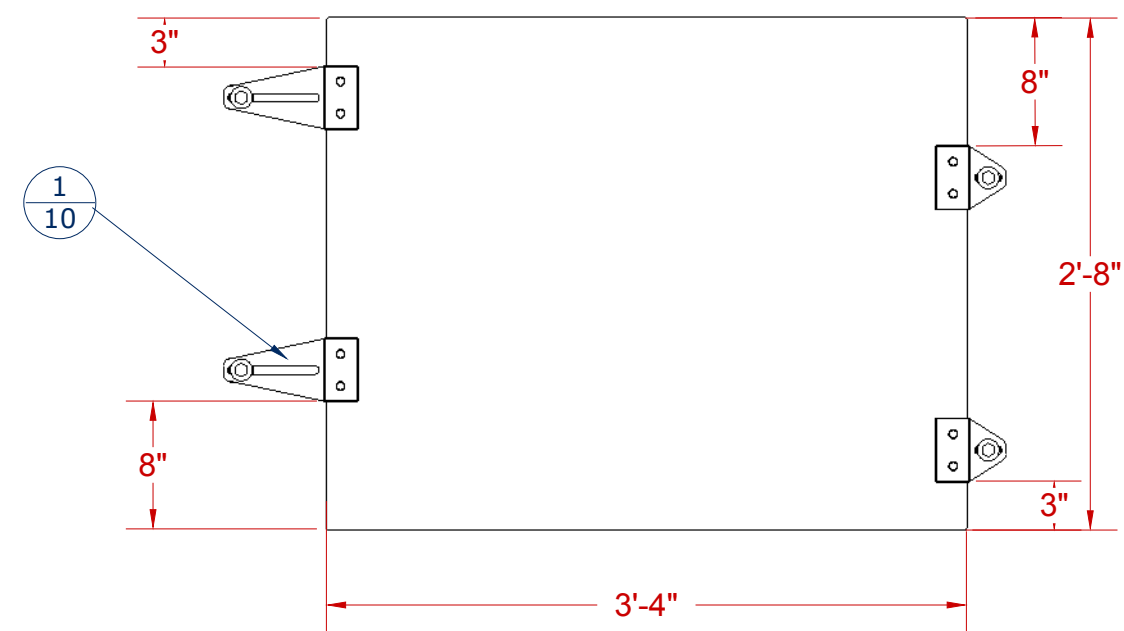

**2** PANEL D-S  
SCALE: 1"=1'-0"

NOTES:

1. ALL OUTER EDGES OF PANELS SHOULD BE ROUNDED OVER AT LEAST 1/8"
2. EACH PANEL HAS 4 BRACKETS AT CONSISTENT POSITIONING FOR MODULAR INSTALLATION
3. FRONT FACE OF EACH PANEL IS BLACK SINTRA, THE BACK DARK GREY SINTRA, AND SURROUNDING 4 SIDES ARE BUILT WITH BLACK SINTRA
4. BRACKETS ARE STEEL, PAINTED WITH A LOW LUSTER BLACK SUPER SPEC PAINT, WITH ZINC PLATED FASTENERS
5. BUILD 6 "D" PANELS AND 2 "D-S" PANELS



UNIVERSITY OF  
PITTSBURGH

STUDIO THEATRE RENOVATION MODULAR PANEL CONCEPT



TOP VIEW



LEFT SIDE VIEW

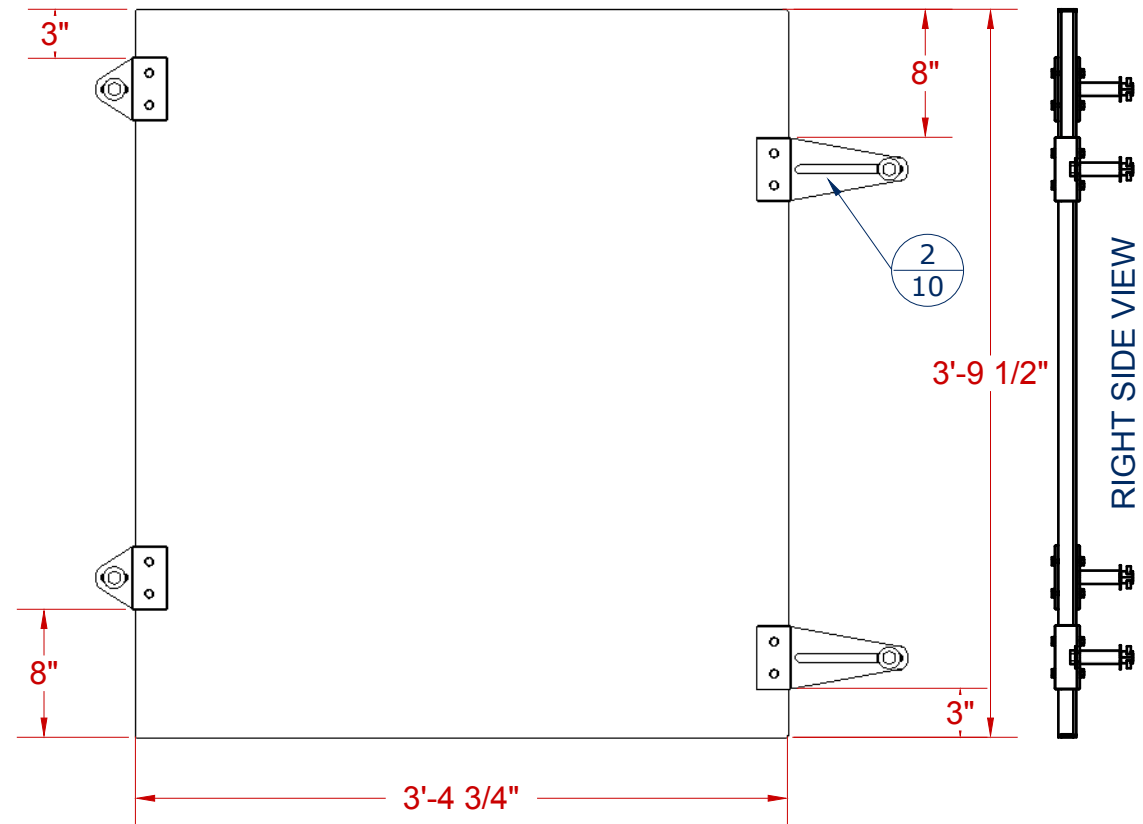

FRONT ELEVATION

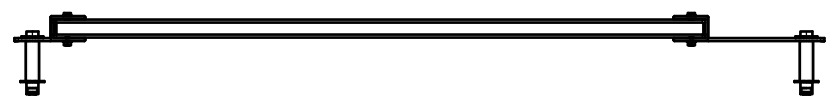

BOTTOM VIEW

**1** PANEL E  
SCALE: 1"=1'-0"

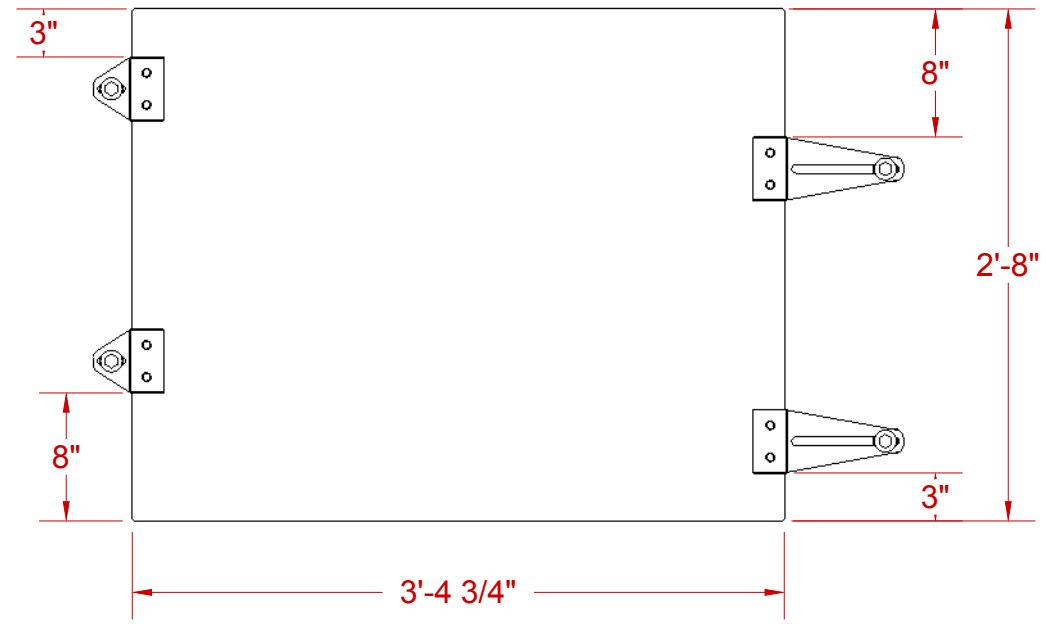

**2** PANEL E-S  
SCALE: 1"=1'-0"

- NOTES:
1. ALL OUTER EDGES OF PANELS SHOULD BE ROUNDED OVER AT LEAST 1/8"
  2. EACH PANEL HAS 4 BRACKETS AT CONSISTENT POSITIONING FOR MODULAR INSTALLATION
  3. FRONT FACE OF EACH PANEL IS BLACK SINTRA, THE BACK DARK GREY SINTRA, AND SURROUNDING 4 SIDES ARE BUILT WITH BLACK SINTRA
  4. BRACKETS ARE STEEL, PAINTED WITH A LOW LUSTER BLACK SUPER SPEC PAINT, WITH ZINC PLATED FASTENERS
  5. BUILD 6 "E" PANELS AND 2 "E-S" PANELS



UNIVERSITY OF PITTSBURGH

**STUDIO THEATRE RENOVATION MODULAR PANEL CONCEPT**

ALL EDGES OF ALL PANELS ROUND OVE 1/16"

NOTES:

1. ALL OUTER EDGES OF PANELS SHOULD BE ROUNDED OVER AT LEAST 1/8"
2. EACH PANEL HAS 4 BRACKETS AT CONSISTENT POSITIONING FOR MODULAR INSTALLATION
3. FRONT FACE OF EACH PANEL IS BLACK SINTRA, THE BACK DARK GREY SINTRA, AND SURROUNDING 4 SIDES ARE BUILT WITH BLACK SINTRA
4. BRACKETS ARE STEEL, PAINTED WITH A LOW LUSTER BLACK SUPER SPEC PAINT, WITH ZINC PLATED FASTENERS
5. INNER STRUCTURE OF PANELS IS MADE OF 3/4" ALUMINUM BOX TUBE MITERED AT THE CORNERS WITH THE INNER SPACE FILLED WITH RIGID FOAM

1  
9

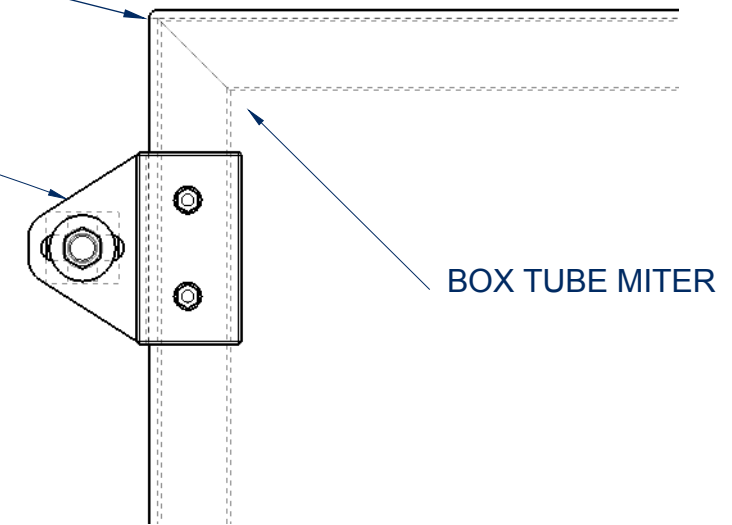

2

PANEL MITER DETAIL

SCALE: 1"=1'-0"

1  
9

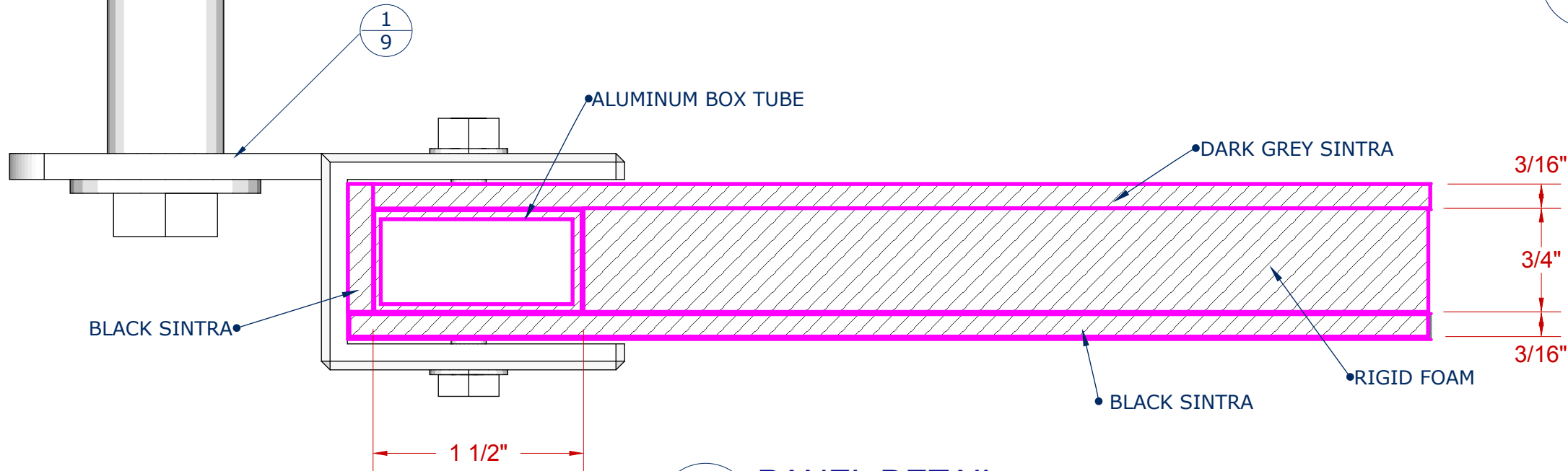

1

PANEL DETAIL

SCALE: FULL SIZE



UNIVERSITY OF  
PITTSBURGH

STUDIO THEATRE RENOVATION MODULAR PANEL CONCEPT



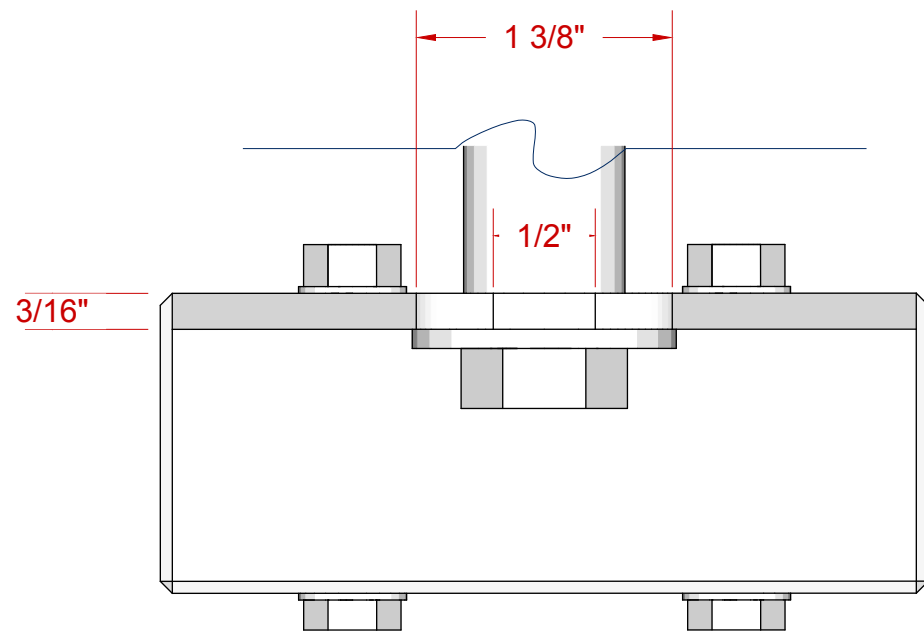

TOP VIEW

NOTES:

1. ALL SIDES OF BRACKETS SHOULD BE FREE OF SHARP EDGES
2. BRACKETS ARE 3/16" (7 GAUGE) STEEL PAINTED WITH A LOW LUSTER BLACK SUPER SPEC PAINT, WITH ZINC PLATED FASTENERS
3. STANDOFF IS REQUIRED TO MOUNT TO EXISTING HARDWARE AND SHOULD BE MADE OF 1/2 PIPE SIZE
4. ALLOW FOR A 1/32"-1/64" GAP BETWEEN THE WALLS OF THE BRACKET AND THE SIDES OF THE PANEL "SANDWICH". OVERALL OPENING OF BRACKETS SHOULD BE BETWEEN 1 3/16" - 1 5/32"
5. HOLES DRILLED FOR 1/4"-20 BOLTS SHOULD BE 17/64" IN DIAMETER, AND THOSE DRILLED FOR THE 1/2" BOLTS SHOULD BE 17/32" WIDE

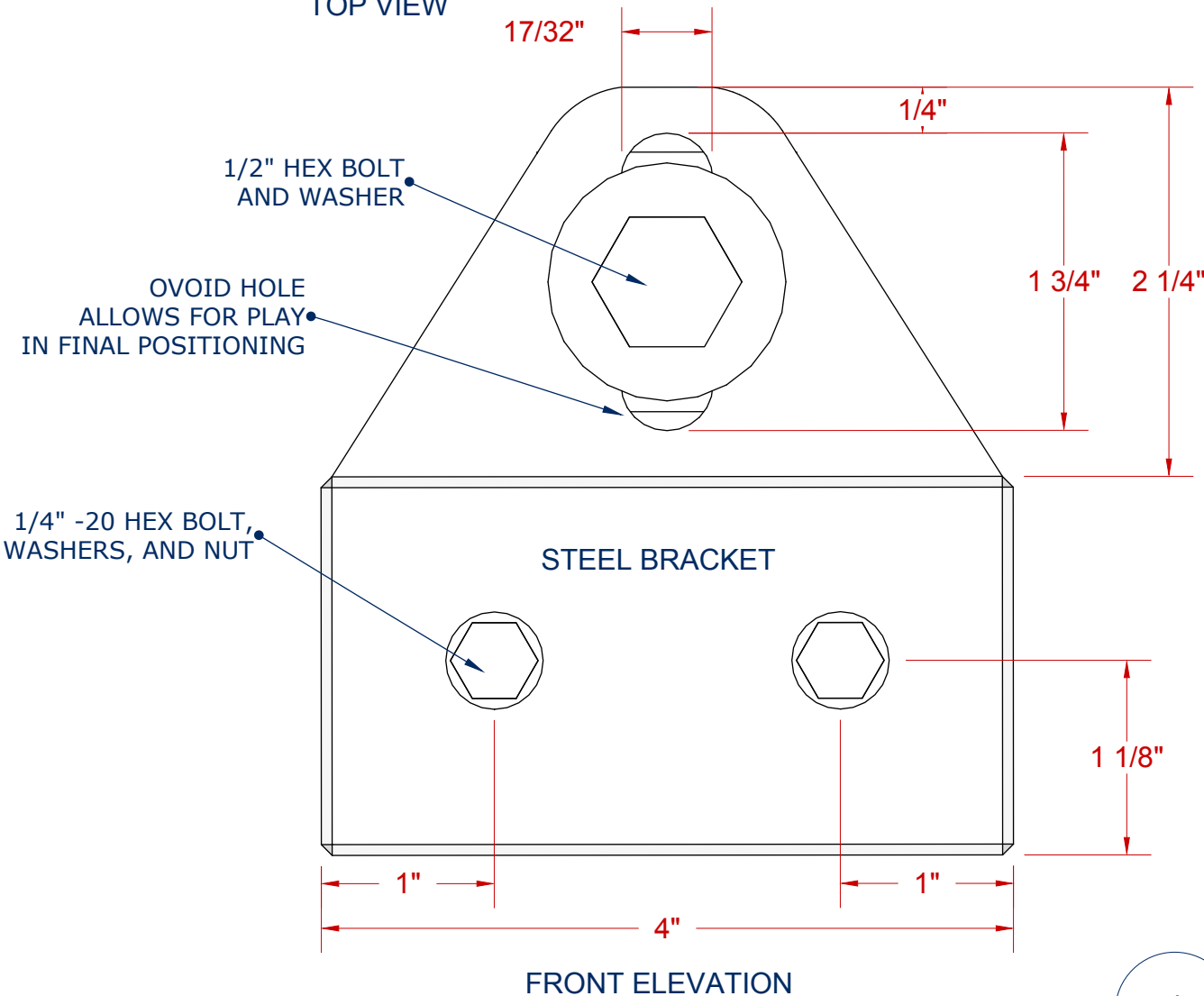

FRONT ELEVATION

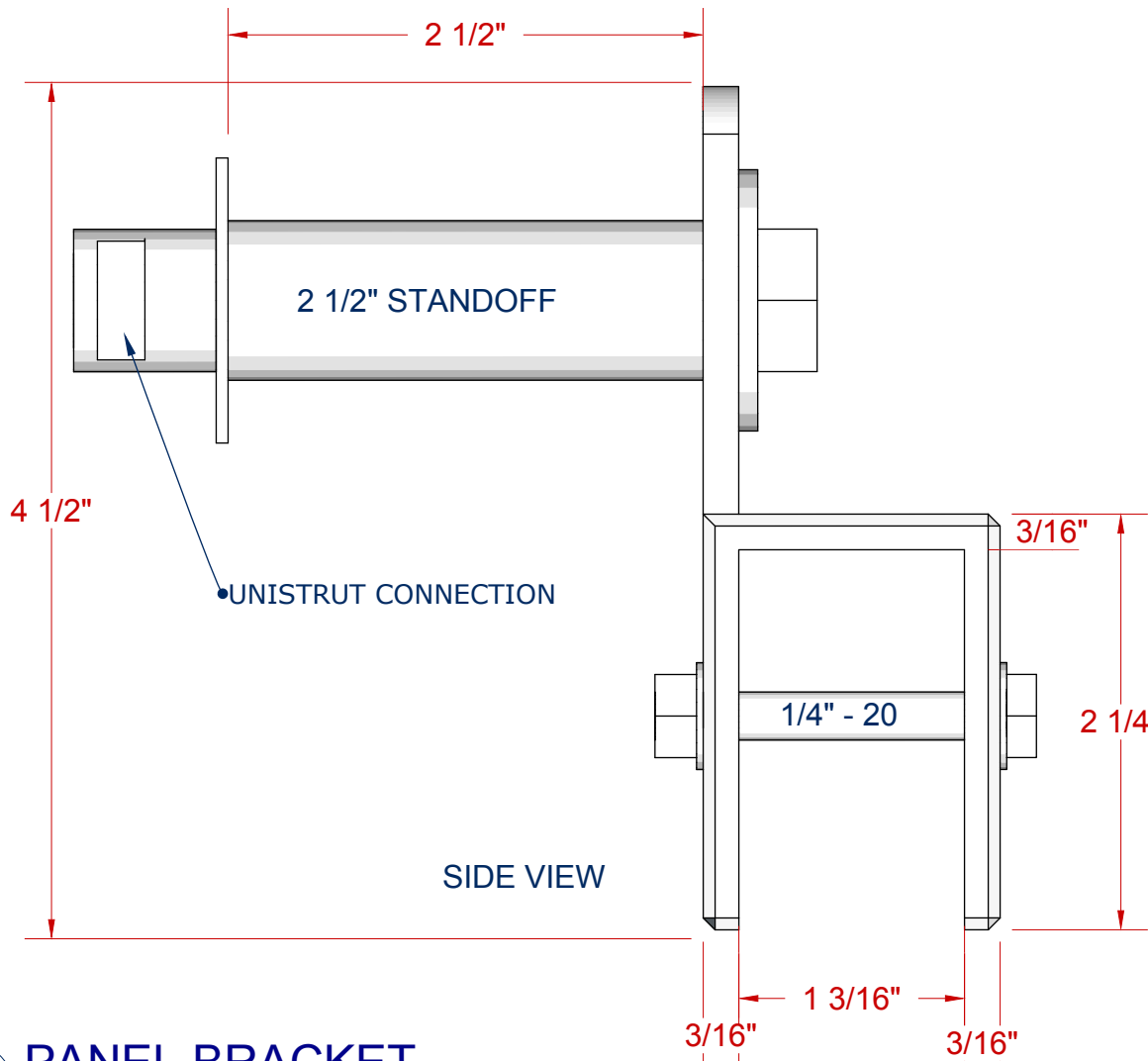

SIDE VIEW

ISOMETRIC VIEW

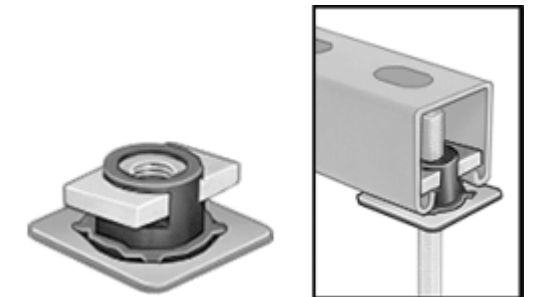
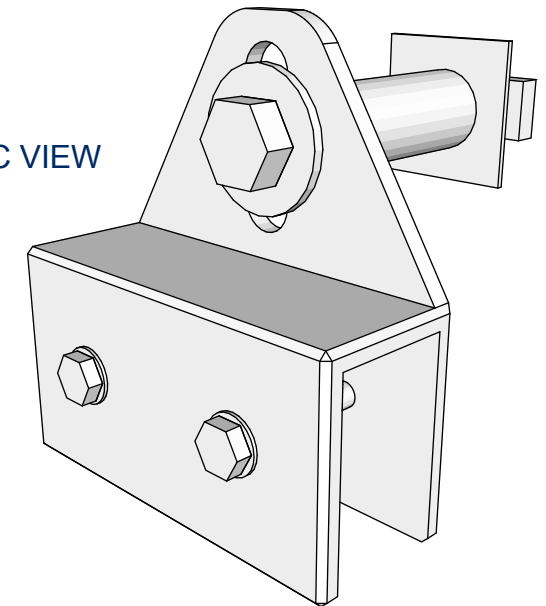

UNISTRUT CONNECTION

**1** PANEL BRACKET  
SCALE: FULL SIZE



UNIVERSITY OF PITTSBURGH

STUDIO THEATRE RENOVATION MODULAR PANEL CONCEPT

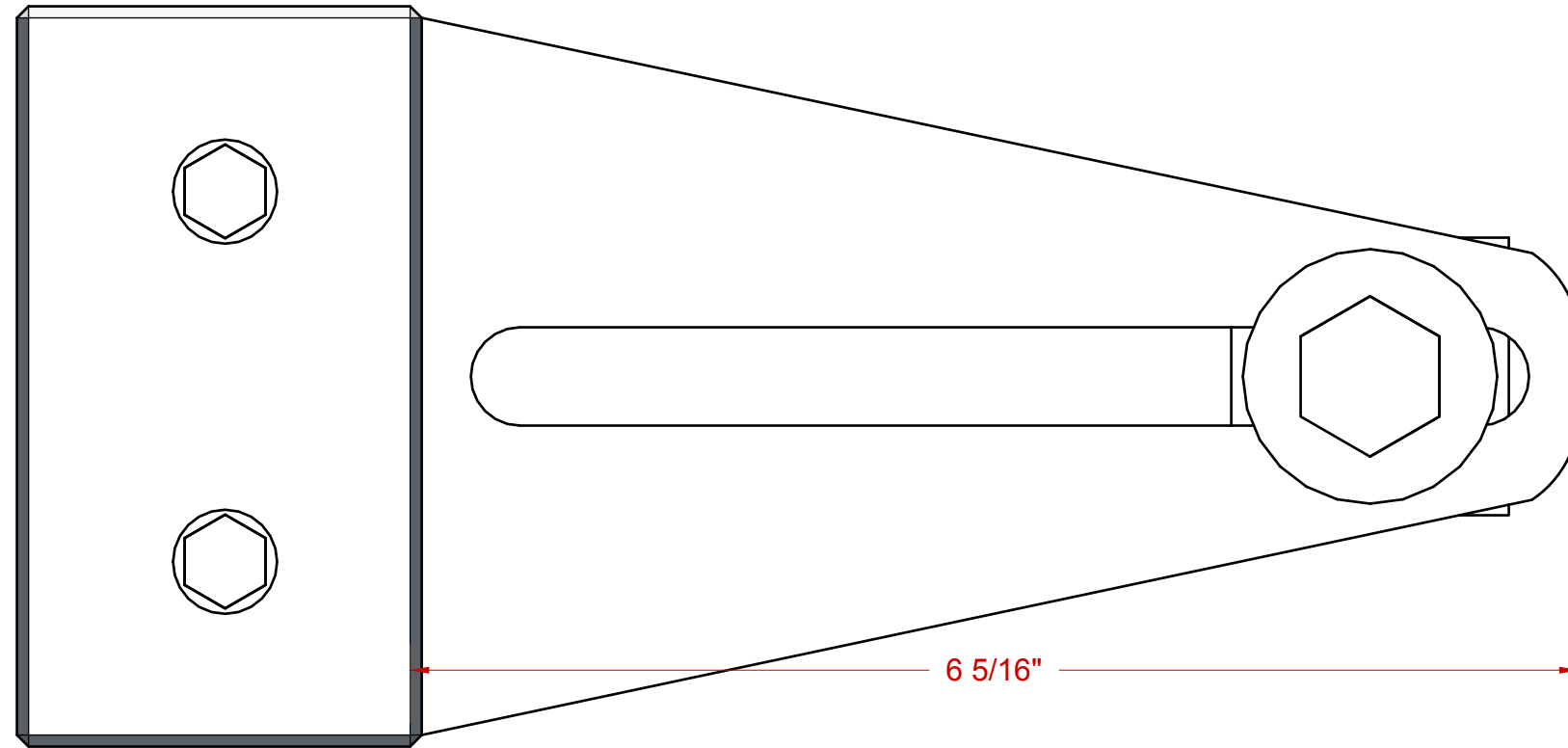

NOTES:  
 1. BRACKETS ARE STEEL, PAINTED WITH A LOW LUSTER BLACK SUPER SPEC PAINT, WITH ZINC PLATED FASTENERS  
 2. D-PANEL BRACKETS AND E-PANEL BRACKETS ARE BUILT SIMILARLY TO THE STANDARD BRACKET, BUT THE SUPPORT IS LONGER TO ALLOW FOR NON-STANDARD CONNECTIONS TO EXISTING ARCHITECTURAL HARDWARE

**1** D-PANEL BRACKET  
 SCALE: FULL SIZE

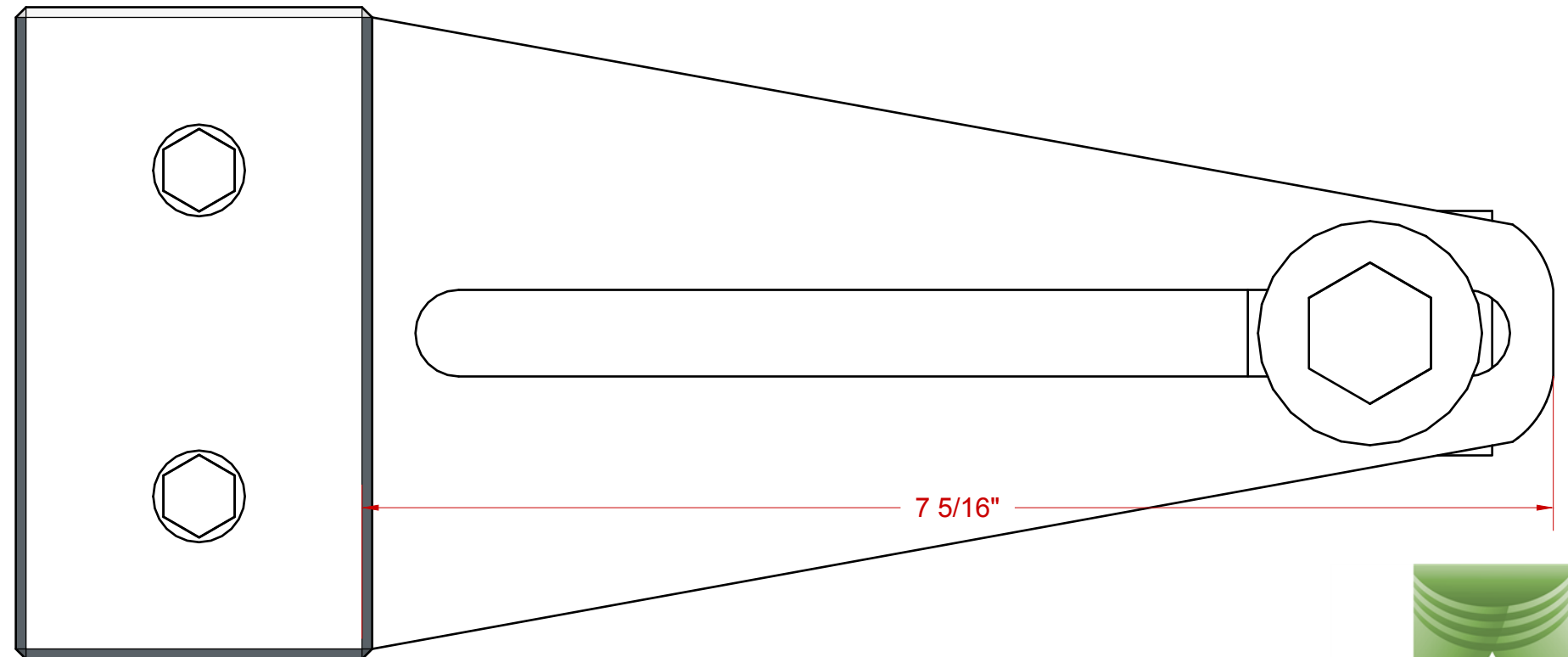

**2** E-PANEL BRACKET  
 SCALE: FULL SIZE



UNIVERSITY OF  
 PITTSBURGH

STUDIO THEATRE RENOVATION MODULAR PANEL CONCEPT

stages

## GENERAL NOTES

- PANELS ARE TO HAVE 90° OUTSIDE CORNERS AND LAY FLAT WITHOUT WARPING.
- ENSURE ALL EDGES/SIDES ARE SMOOTH, AND FREE OF BURRS.
- ENSURE PROPER FIT/ALIGNMENT OF ALL BRACKETS POST-ASSEMBLY.
- BRACKET OPENING SHOULD BE ABLE TO FIT OVER PANEL CLEANLY WITHOUT EXCESSIVE "PLAY". APPROXIMATELY 1/64 - 1/32" GAP ON EITHER SIDE OF PANEL.
- ENTIRE PANEL, ASSEMBLED WITH BRACKETS, SHOULD WEIGH LESS THAN 50 LBS.
- ENSURE BRACKETS ARE UNIVERSALLY SIZED AND DRILLED SO THAT ALL ARE INTERCHANGEABLE IN ANY ORIENTATION.
- LABEL ALL PANELS WITH THEIR PANEL LABEL (I.E.: A, B, D, E) USING A 1/2" STAMP. LABELS SHOULD BE LOCATED NEAR EACH END OF THE PANEL EDGES WITH BRACKETS, NOT TO BE COVERED BY A BRACKET, TWICE PER SIDE.
- PANELS AND BRACKETS ARE TO BE DELIVERED FULLY ASSEMBLED AND COLLATED.
- HARDWARE SPECIFICATIONS ARE PROVIDED USING MCMASTER-CARR REFERENCE NUMBERS. PURCHASE FROM MCMASTER-CARR IS NOT REQUIRED, AS LONG AS THE HARDWARE MATCHES THE SPECIFICATIONS PROVIDED HEREIN.

## SUGGESTED PANEL CONSTRUCTION TECHNIQUES

- WELD ALUMINUM PANELS, GRIND ALL WELDS SO THAT TOP AND BOTTOM FACES OF FRAME ARE SMOOTH.
- ADHERE "TOP" SIDE OF SINTRA FACING WITH CONTACT ADHESIVE TO ALUMINUM FRAME.
- INSTALL AND ADHERE INNER EXPANDED POLYSTYRENE FOAM PANEL (SIZED TO FILL ENTIRE INNER OPENING OF FRAME) TO BE FLUSH WITH ALUMINUM FRAME.
- ADHERE "BOTTOM" SIDE OF SINTRA FACING TO EXPANDED POLYSTYRENE FOAM PANEL AND ALUMINUM FRAME WITH CONTACT ADHESIVE.
- ROUTE ALL EDGES SMOOTH WITH FLUSH-CUTTING ROUTER BIT.
- CAP THE 4 THIN SIDES WITH BLACK SINTRA WITH CONTACT ADHESIVE AND ROUTE FLUSH.
- ROUND OVER ALL EDGES (INCLUDING CORNERS) WITH 1/8" CORNER-ROUND ROUTER BIT.

## STANDOFF CONSTRUCTION NOTES

- CUT SCHEDULE 40 - 1/2 PIPE TO 2 1/2" LONG
- CENTER PIPE OVER 1/2" HOLE AND TACK WELD TO TWIST LOCK UNISTRUT
- PAINT USING SUPER SPEC HP D.T.M.



UNIVERSITY OF  
PITTSBURGH

## STUDIO THEATRE RENOVATION MODULAR PANEL CONCEPT

## MATERIALS

- **PANELS**
  - ¾" X 1 ½" ALUMINUM TUBE, .125" NOMINAL WALL THICKNESS
  - ¾" EXTRUDED POLYSTYRENE FOAM
  - 5MM (3/16") SINTRA SUBSTRATE (DARK GREY AND BLACK COLORS)
  - PERMANENT CONTACT ADHESIVE
- **BRACKETS**
  - 3/16" (7 GA) STEEL
  - SUPER SPEC HP D.T.M. ACRYLIC LOW LUSTRE (P25) - BLACK COLOR
- **BRACKET HARDWARE**
  - ZINC-PLATED GRADE 5: ¼"-20 BOLTS, 1-¾" LONG
    - MCMASTER-CARR # 91247A548
  - ZINC-PLATED GRADE 8: ¼"-20 HEX FLANGE LOCKNUTS
    - MCMASTER-CARR # 98233A100
  - ZINC-PLATED GRADE 5: ½"-13 BOLTS, 4" LONG
    - MCMASTER-CARR # 91247A728
  - ZINC-PLATED STEEL SAE FLAT WASHER: ½" SIZE, 1-1/16" OD
    - MCMASTER-CARR # 90126A033
- **STANDOFF HARDWARE**
  - SCHEDULE 40 STEEL ½ PIPE (CUT TO 2-½")
    - MCMASTER-CARR # 7750K231
  - TWIST LOCK WASHER/NUT FOR 1-5/8" STRUT, FITS ½" THREAD
    - MCMASTER-CARR # 3260T13
  - SUPER SPEC HP D.T.M. ACRYLIC LOW LUSTRE (P25) - BLACK COLOR

## BUILD INVENTORY

- **PANELS**
  - PANEL SIZE "A": 12
  - PANEL SIZE "A-S": 4
  - PANEL SIZE "B": 110
  - PANEL SIZE "B-S": 36
  - PANEL SIZE "D": 6
  - PANEL SIZE "D-S": 2
  - PANEL SIZE "E": 6
  - PANEL SIZE "E-S": 2
- **BRACKETS**
  - STANDARD BRACKET: 700
  - "D" SIZE BRACKET: 20
  - "E" SIZE BRACKET: 20
- **HARDWARE**
  - STANDOFFS: 720



UNIVERSITY OF  
PITTSBURGH

## STUDIO THEATRE RENOVATION MODULAR PANEL CONCEPT